

AVAILABLE OFFICE SPACE FOR LEASE

TIMES SQUARE

5201 S. Broadway
Suite 200

Building Specifications

Available Space: 7840 SF

Possession: June 1, 2022

Lease Rate: Negotiable

- *Fitzpatrick Architects Designed Floor Plan*
- *Two Large Conference Rooms*
- *Signage on S. Broadway Pylon*
- *Large Open Office Concept*
- *Break Room with Kitchen*
- *S. Broadway Frontage*

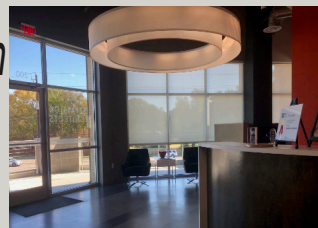

Call us at (903) 509-8161
www.pyle-properties.com



PYLE PROPERTIES
212 Old Grande Suite C-100
Tyler, TX 75703

Suite 200 Floor Plan

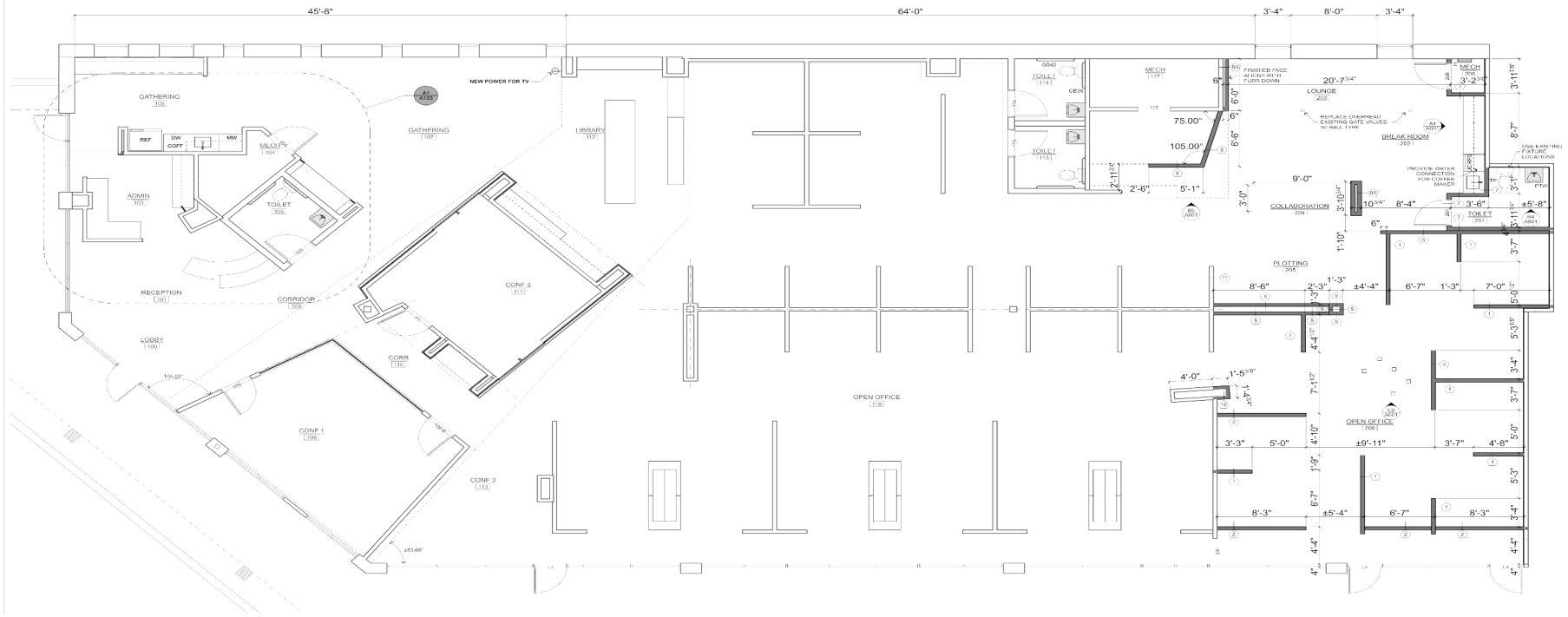

7840 Square Feet